

HT User's Manual

HCS-W1002

HYUNDAI HT Co., Ltd.



6320000424 REV.0



01 Precautions on use



It contains some issues that can result in a serious injury or even death. Please read and be fully aware of the contents for the correct use of the device.

- Before use, remove all protective caps and plastic device.
- Any attempts of disassembly, repair and remodeling are prohibited.
- Do not use water or chemicals, such as alcohol to wipe the outside of the device. Use only a piece of dry cloth.
- Do not install the device in a place where is hot or humid and do not expose the product to direct sunlight.
- Do not have the device exposed to a physical impact, smoke, oil or water.
- If there is any abnormal noise, smell or smoke coming out of the device, stop using it immediately and call the Service Center.
- Do not place the device around any magnet stuff like TV or Speaker.
- This device is not operated in case of power shutdown or failure.
- The device should be connected with wireless router via Wifi protocol.
- Do not allow water to come in contact with the device.
- Do not use a stylus, fingernail or sharp object as it may damage the device.

02 External Structure and Description

I Front view

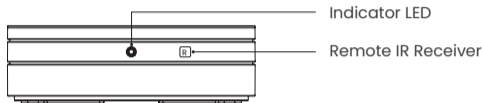

I Upper view

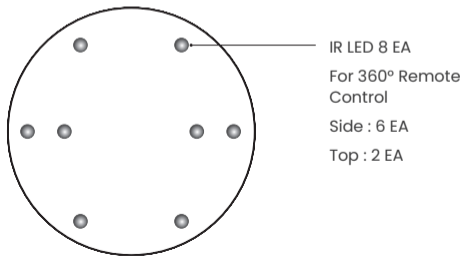

03 How to connect Power and IR cables

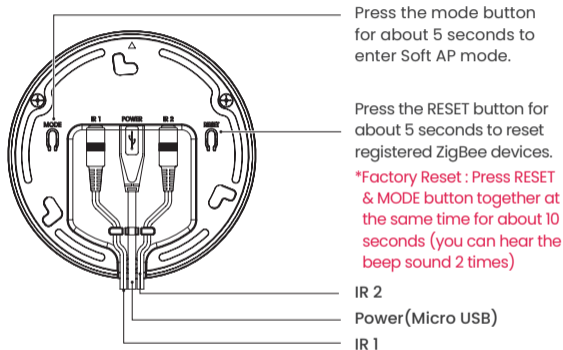

*IR cable is an optional and IR cable length can be extended by a link cable.

*Link Cable Plug Spec : $\varnothing 3.5\text{mm}$, 2Pole

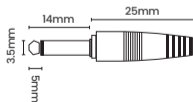

04 How to install

I Ceiling mounting

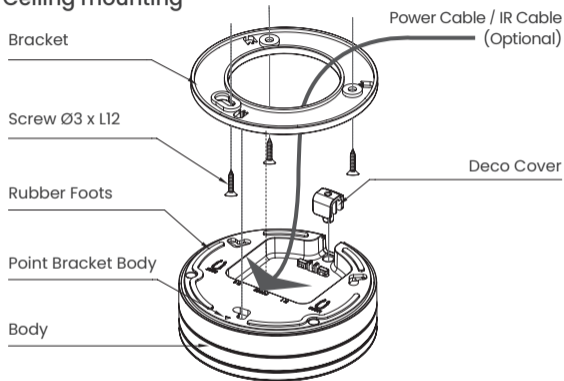

- ① Install the screws ($\varnothing 3 \times \text{L12}$ 3ea) on proper location where it sets.
- ② Assemble the "Deco Cover" on the device.
- ③ Connect the power and IR cable (Optional) in each port on the bottom of the main unit through bracket.
- ④ Assemble the main unit and the bracket.

Place on the desk

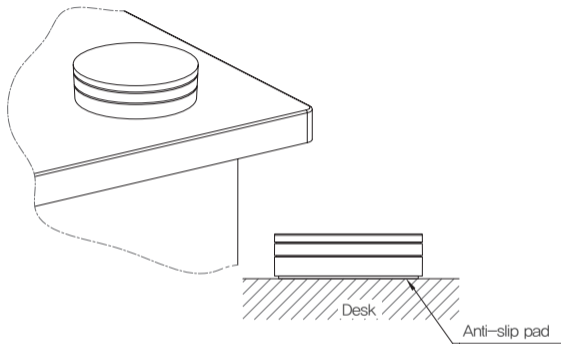

- 1 Connect the power and IR cable (Optional) in each port on the bottom of the main unit.
- 2 Put the main unit on proper location. (Rubber feet are attached on the bottom side)

6 *Recommend you not to install the device on the floor considering that the wireless signal coverage may be unstable.

05 Components



Main Unit x 1



Bracket x 1



Screw(Ø3xL12) x 3



Power Cable(1.2M) x 1



IR Cable(2M) x 2
(Optional)



Deco Cover x 1



User's Manual x 1



App Manual x 1



Power Adaptor x 1

06 Product Specification

HCS-W1002

Item	Detail	
Rated Voltage	External DC Adaptor(DC 5V/1A)	
Power Consumption	Max. 2.5W	
Size	109.15(Ø)mm X 38.5(T)mm	
Weight	150g	
Environment	Temperature	0°C ~ 40°C (Indoor)
	Humidity	Below 80%
Protocol	2.4GHz WLAN(802.11b/g/n), Zigbee, IR Remote Control	
Manufacturer	HYUNDAI HT Co., Ltd. / Made in Korea	

Warranty Conditions

HYUNDAI HT Products are supplied with _____ return to base warranty from the date of purchase, We will repair or replace the defective item with a new or factory rebuilt replacement.

Condition

1. This warranty applies to the original purchaser only.
2. All warranty will be invalid if unauthorized repair or modification are made to the unit or in any case of accident, misuse and damage cause by improper installation and altered serial numbers.
3. The liability of **HYUNDAI HT** is limited to the cost of repair/replacement of the unit under warranty.
4. If you need a warranty service, you should send the product to our customer service Dept. or dealer office. The product in all cases must be accompanied by the following items : Your name, address, telephone number, the serial number and copy of your sales receipt showing the purchase date.

The Model Number is on the box and front of the manual, The Serial Number is on the bottom of the unit, Record the Model and Serial Numbers in the spaces provided below, Refer to these numbers for warranty service.

Model No. _____

Serial No. _____

HCS-W1002

HYUNDAI HT Co., Ltd.

www.hyundaiht.co.kr

107, Yeouidaebang-ro,

Yeongdeungpo-gu, Seoul, 07433, Korea

(HYUNDAI HT Building, Shingil-dong)

Tel +82.2.2240.9234/9271



6320000424 Rev 00